

CONCEPT

“পবিত্র নদীর সাথে সত্তার সংযোগ” 𑂔

“Conjunction of entity with sacred river”

As per Hindu tradition people connect with this river at various stages of their Life cycle  
Brahmaputra supports a great depth of history, tradition, and use.

Langalbandh refers to “the place where the plough was stopped”. In short, to bring this holy water to people, Lord Porshuram starts digging from the Everest and stopped here. From this myth, this place gets the name Langalbandh. There is a big historical myth of langalbandh.

According to puran (Holy book) , most Hindu people believe that the blessings of all the holy places of the world are pooled in the waters of Brahmaputra on the auspicious day of Chaitra and by touching the water a believer becomes free of all sins and attains eternal salvation.

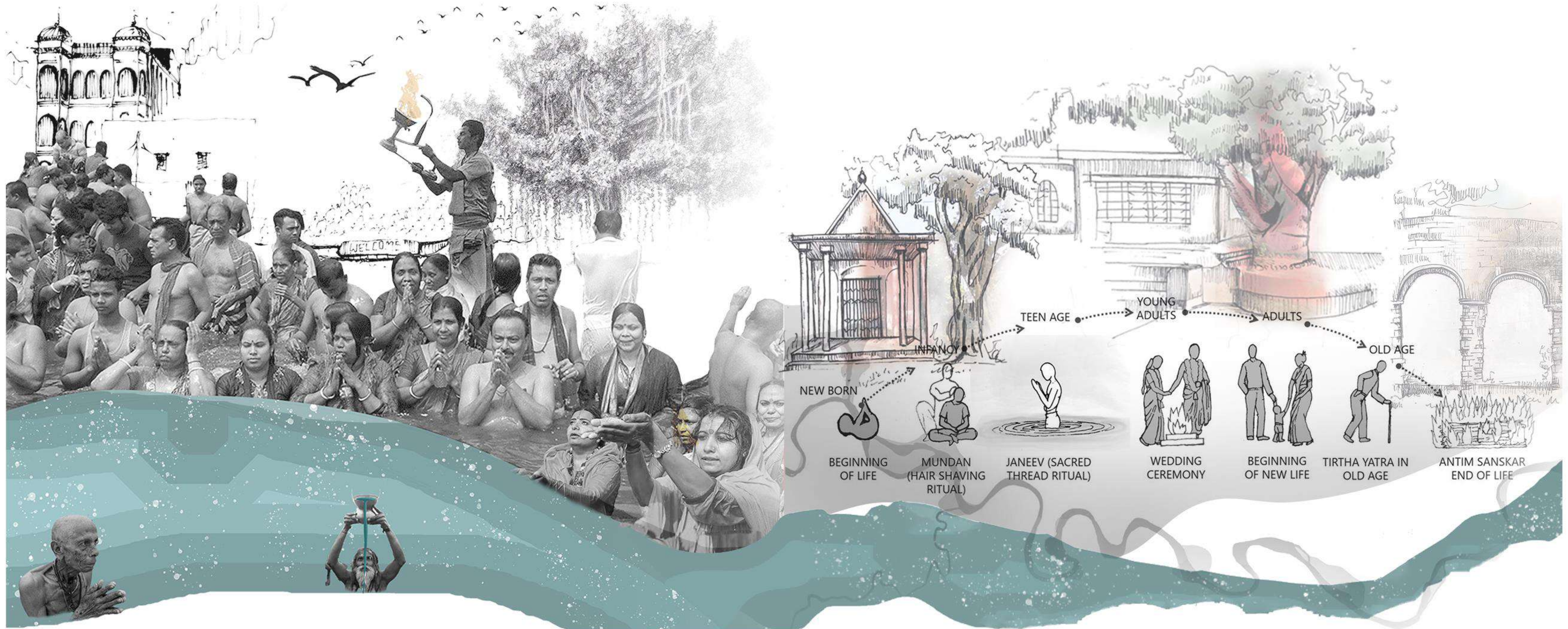

# LOCATION

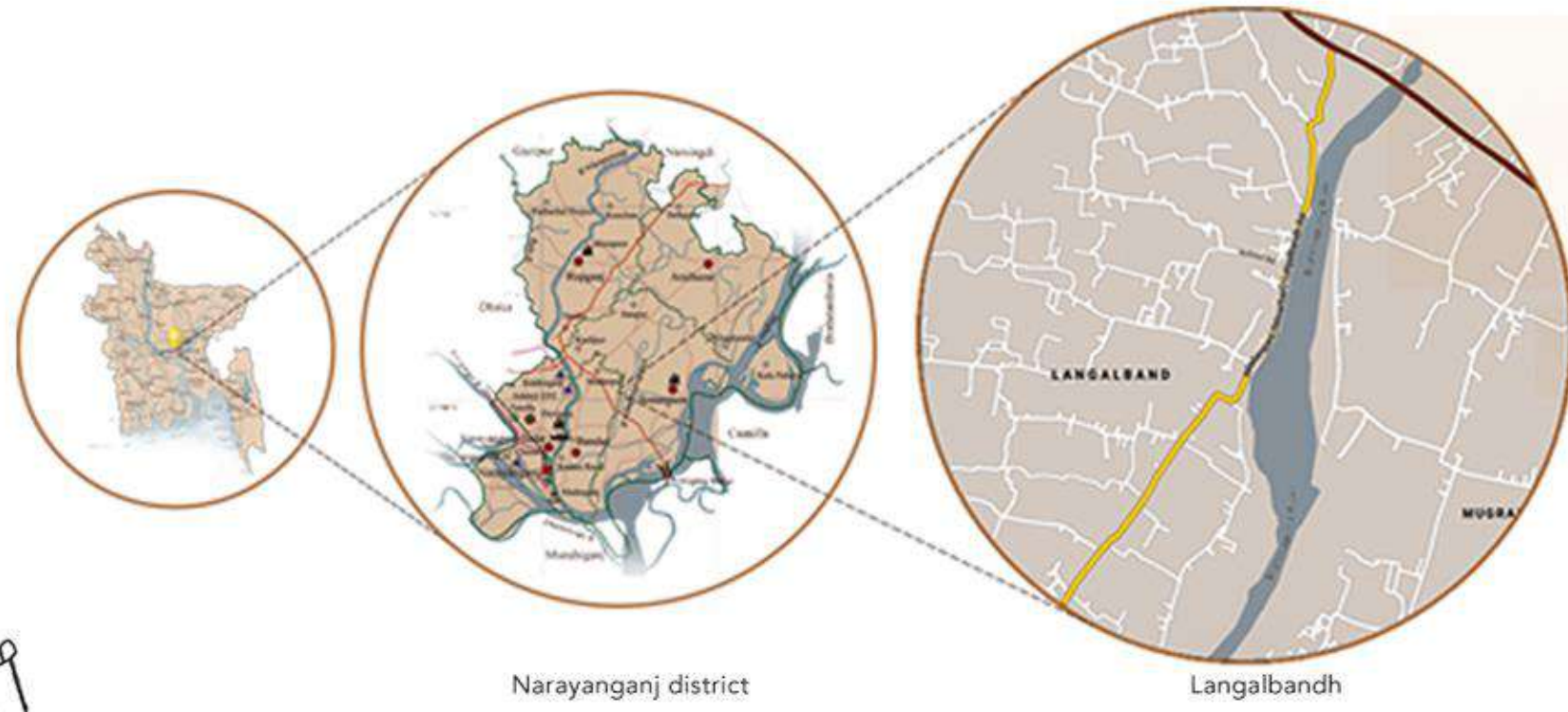

Narayanganj district

Langalbandh



It is located in Bandar Upazila of Narayanganj District, on the bank of the Brahmaputra River near the Dhaka-Chittagong highway.

# ACCESSIBILITY

- Sylhet  
237 km
- Lalmonirhat  
362 km
- Dinajpur  
366 km
- Bogra  
220 km
- Rajshahi  
278 km
- Pabna  
175 km
- Jessore  
234 km
- Chittagong  
217 km

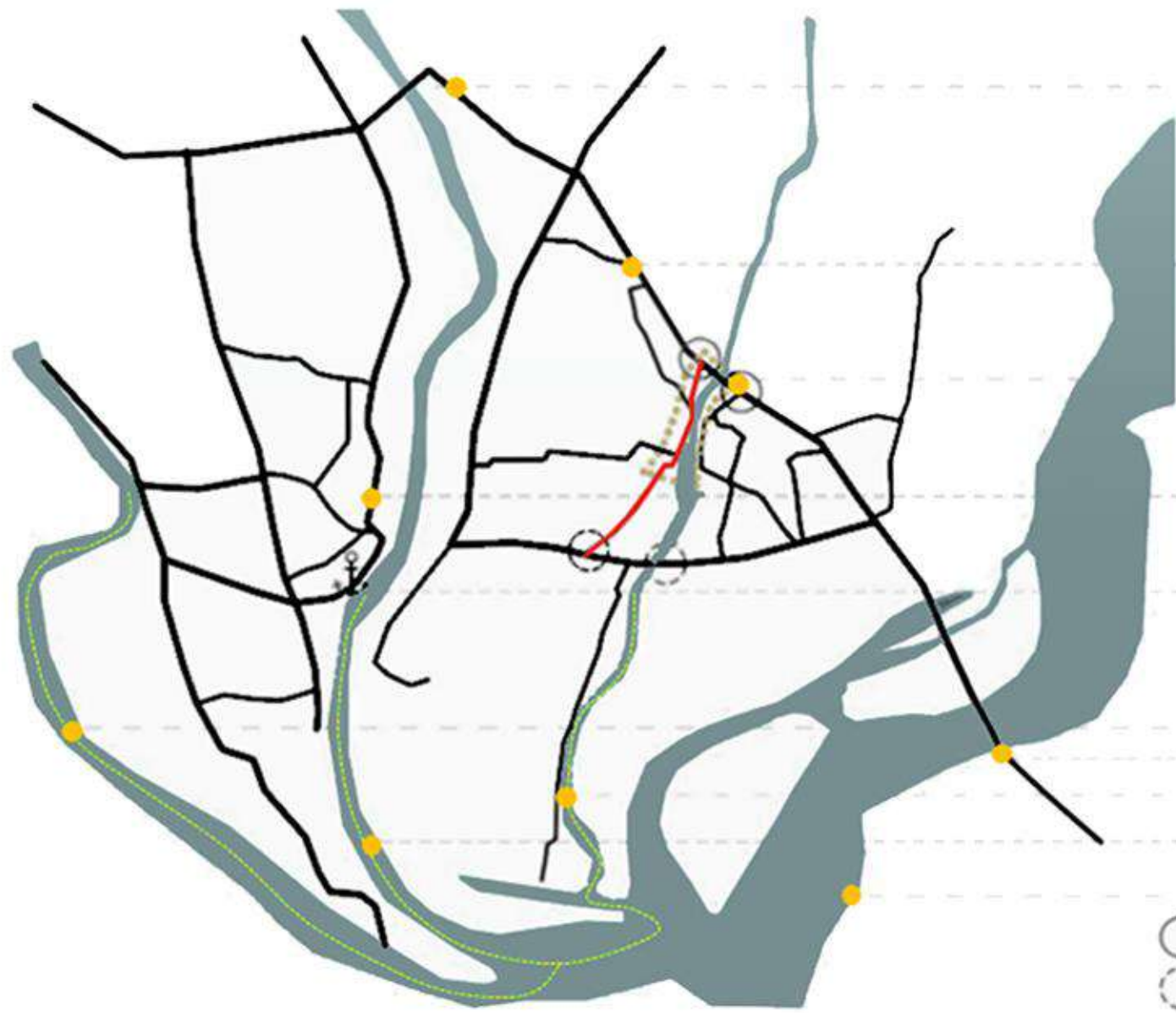

- Kachpur bridge
- Dhaka- Ctg highway
- Brammaputra bridge
- Narayanganj city corporation
- Narayanganj port
- Buriganga river
- Meghna bridge
- Brammaputra river
- Shitalakha river
- Meghna river
- Approach to langalbandh
- Potential future approach
- ..... Water route
- ..... Langalbandh Tirtha area



# ENTRY MAP



- Car icon: Normally rickshaw & auto rickshaw serve this area. But truck & private car also use this road
- Truck icon
- Auto-rickshaw icon
- Moped icon
- Bicycle icon
- (Parking)

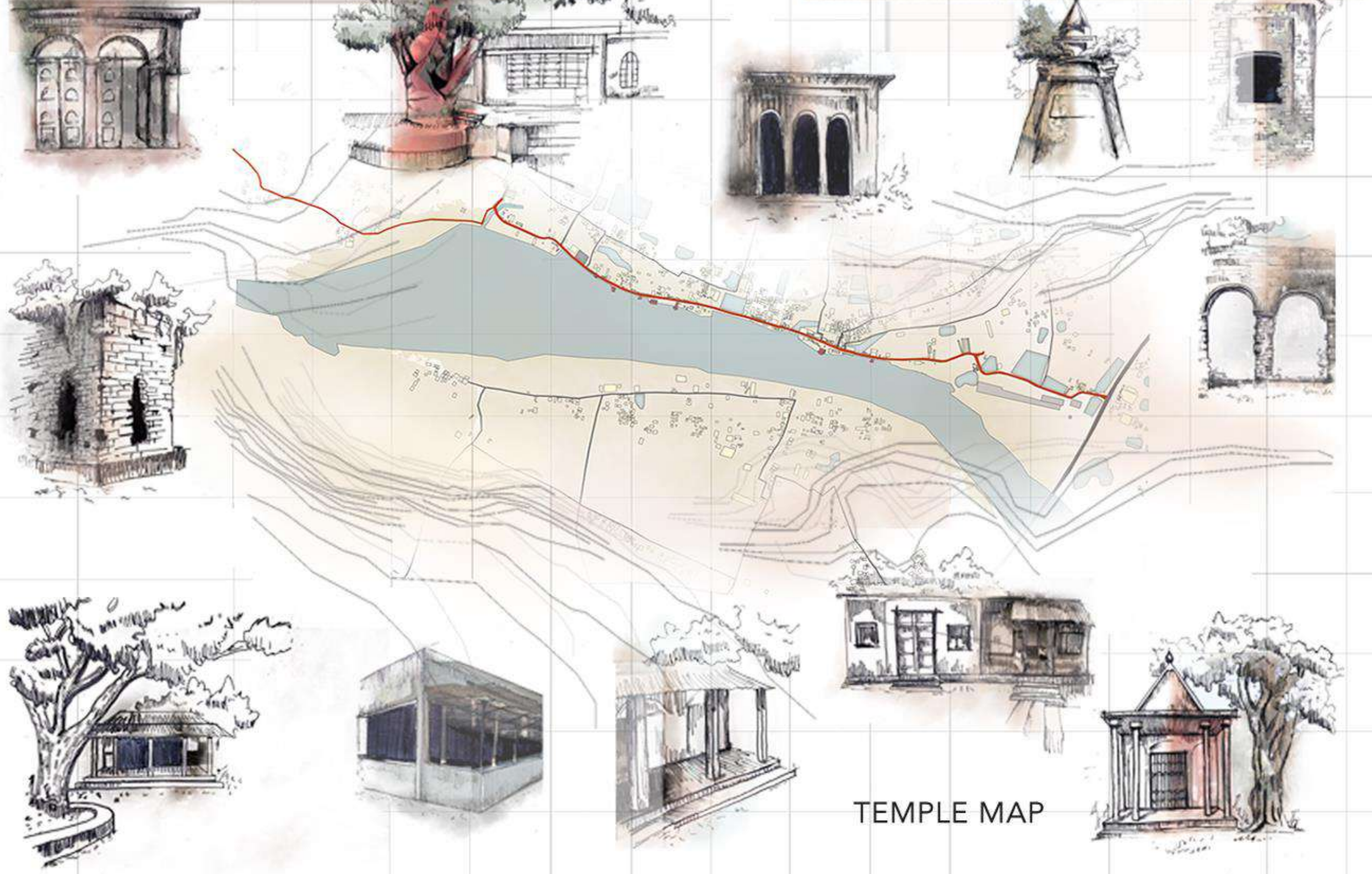

# TEMPLE MAP



Existing condition



Discontinued Ghat



DURING HOLY BATH

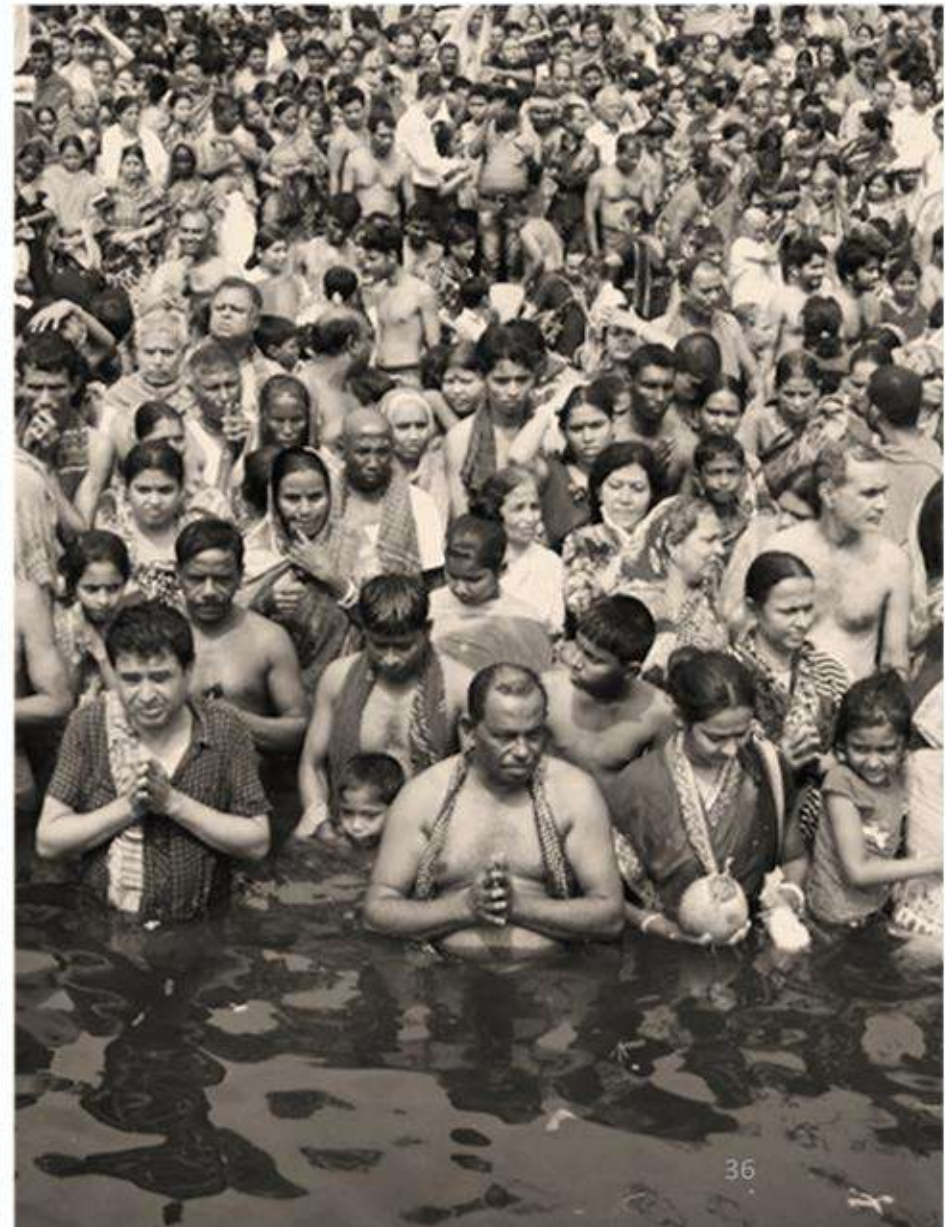

Shoshan kali temple

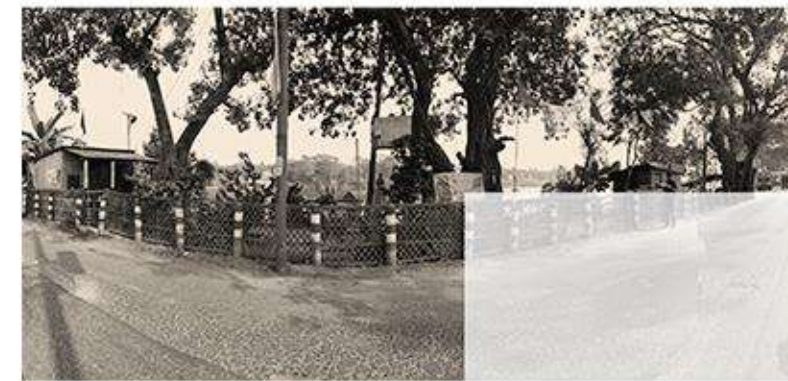
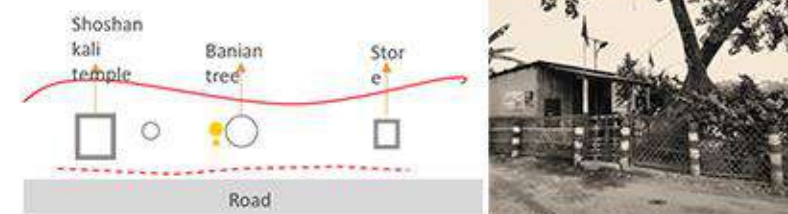

Pashan kali temple

Locality says, Pashan kali temple also renovated around 85-90 years ago by Hindu business man like Annayapurna temple.



Existing Temple Condition

Annapurna Temple

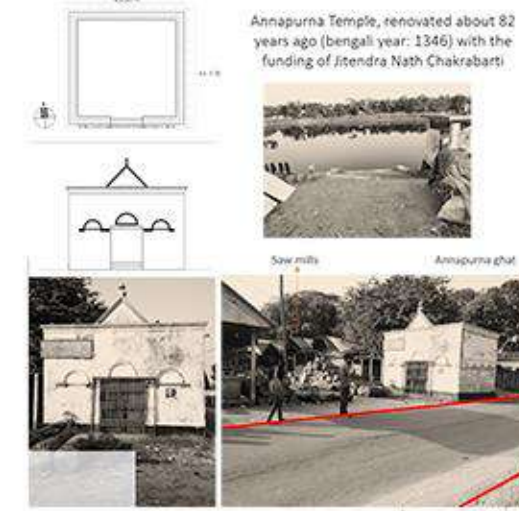

Annapurna Temple, renovated about 82 years ago (bengali year: 1346) with the funding of Jitendra Nath Chakrabarti.

Sri. Beni Madhab bramachari asrom

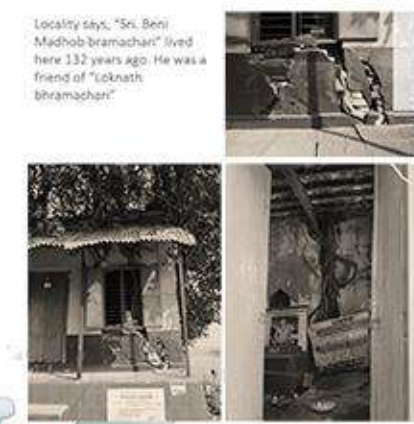

Locality says, "Sri. Beni Madhab Bramachari" lived here 132 years ago. He was a friend of "Loknath Bramachari".

Gauranga Mahaprabhu Temple

Gauranga Mahaprabhu Temple, constructed by Sri Nandakumar Poddar 120 years ago (bengali year: 1308)

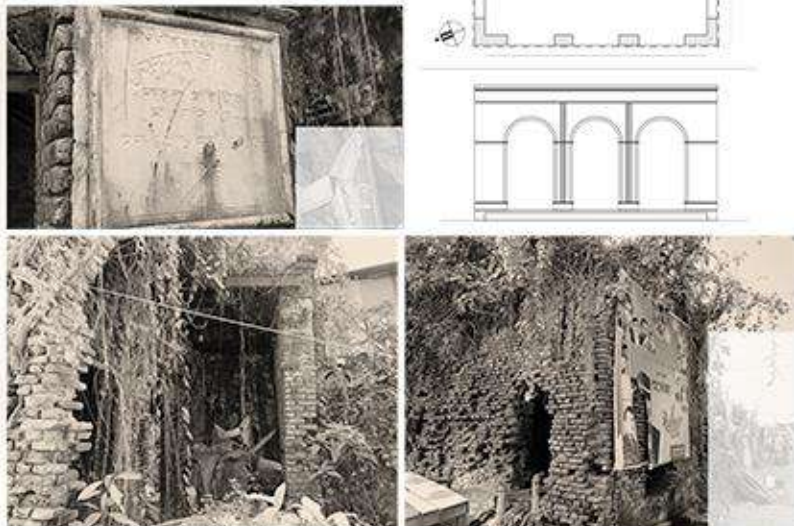

Shib parboti moth

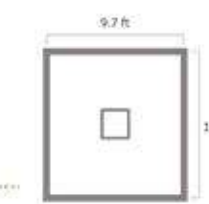

This temple also have no name plate. Locality says, Shib parboti moth was built 100-120 year ago by Business man of Fatibazar.



Makori shadur asrom

Makori shadur passed away 77 years ago. Now this asrom is taken care by his grand son.

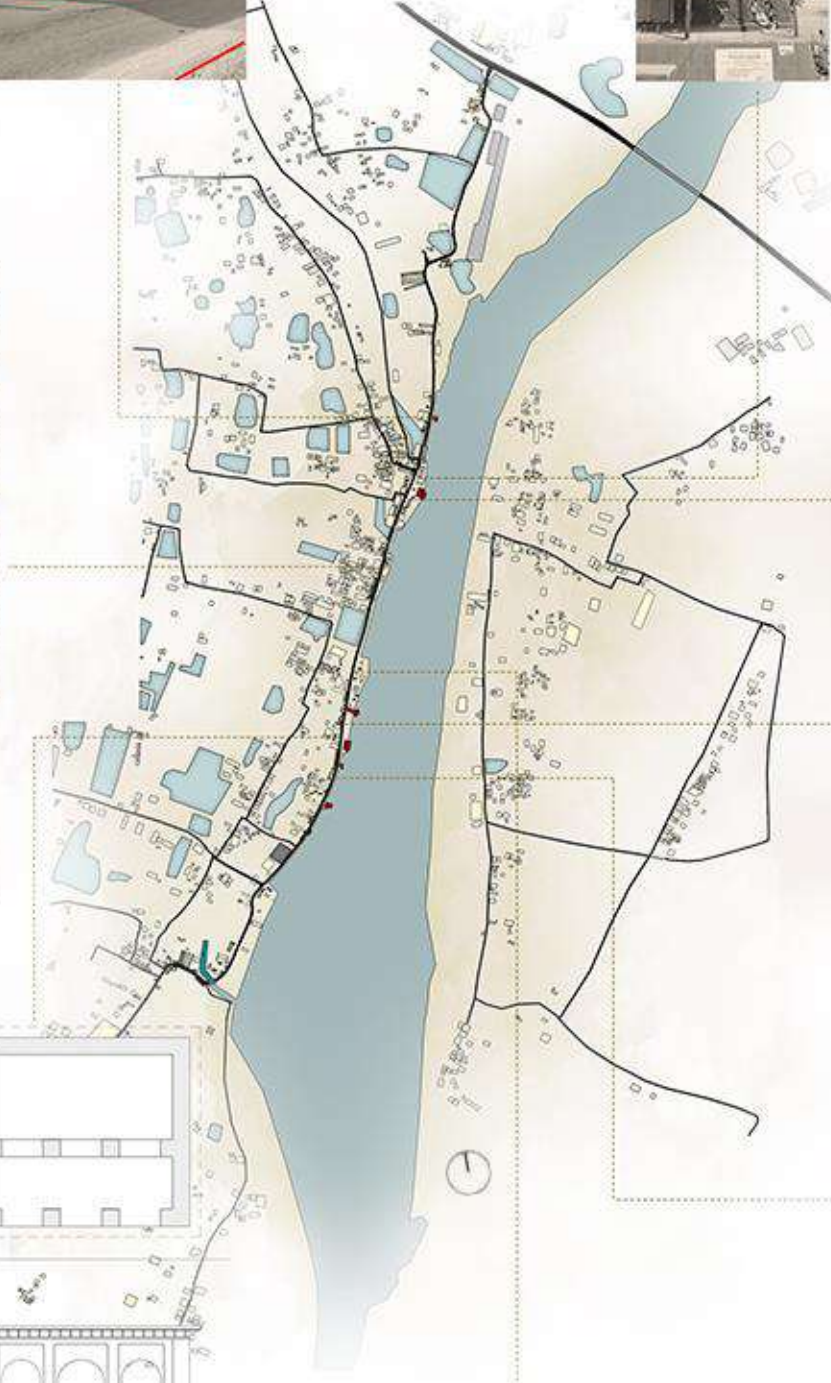

**EXISTING CONDITION**

- DHAKA-CTG HIGHWAY
- SECONDARY ROAD (LANGALBANDH)
- TERTIARY ROAD (LANGALBANDH)
- BRAHMAPUTRA RIVER
- TEMPLE

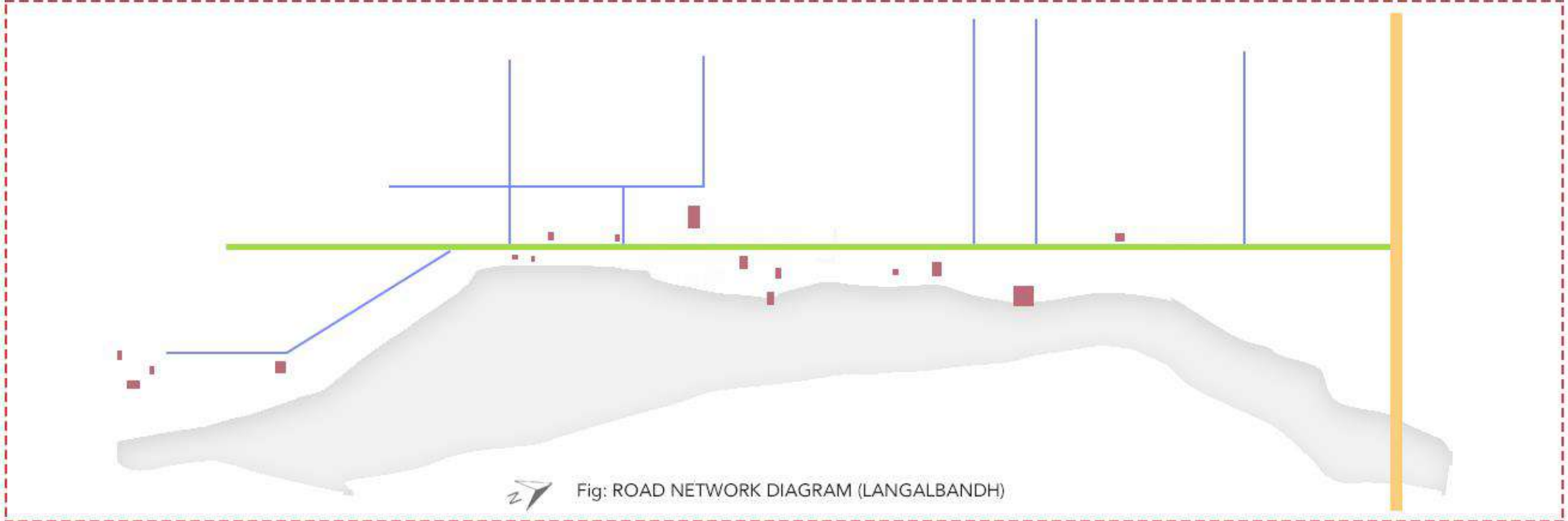

The current road (secondary road) has been altered to a pedestrian path during festival. For worship and bathing, pilgrims travel here to the ghats and sacred temples.

**ISSUES**

- Narrow road – congestion of road during festivals/sacred journey.
- Poor condition of Ghat & Temple.
- Discontinuation of Ghat & Temple.
- Not pedestrian friendly.
- Poor condition of urban infrastructure.



**PHASE- 01**

- Narrow road – congestion of road during festivals.
- Discontinuation of Ghat & Temple.
- Not pedestrian friendly.

**SOLUTION**

- PROPOSING A BYPASS VEHICULAR ROAD
- PROPOSING A RIVERSIDE POMANADE

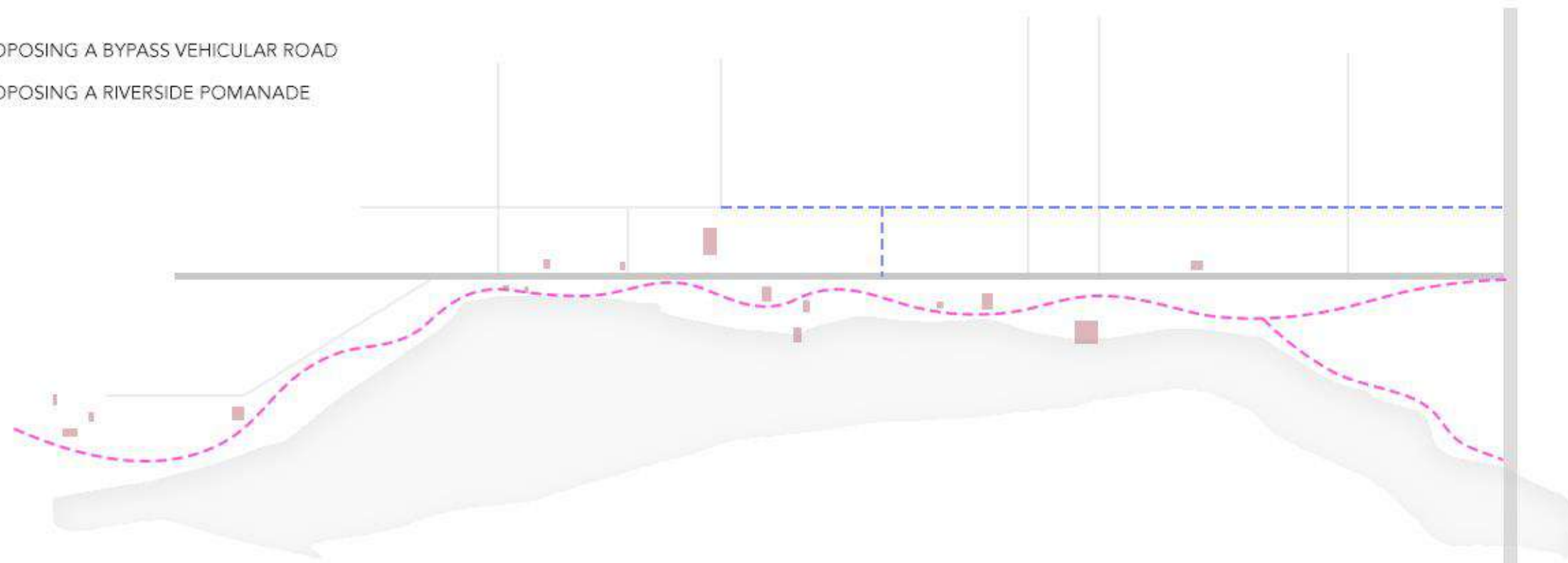

After analyzing the accessibility and circulation of the yearly festivities I tried to make a decision. Considering that during the event, the current road is a pedestrian walkway. So I suggested that the issue could be solved by creating a parallel bypass road that would be linked to the pedestrian road at regular intervals, with each section acting as a loop. Once more, there is no pavement, so I suggested building a promenade along the river to link the ghat and temple also.

- Proposed vehicular road
- Secondary road
- Riverside promenade
- Dhk-Ctg highway

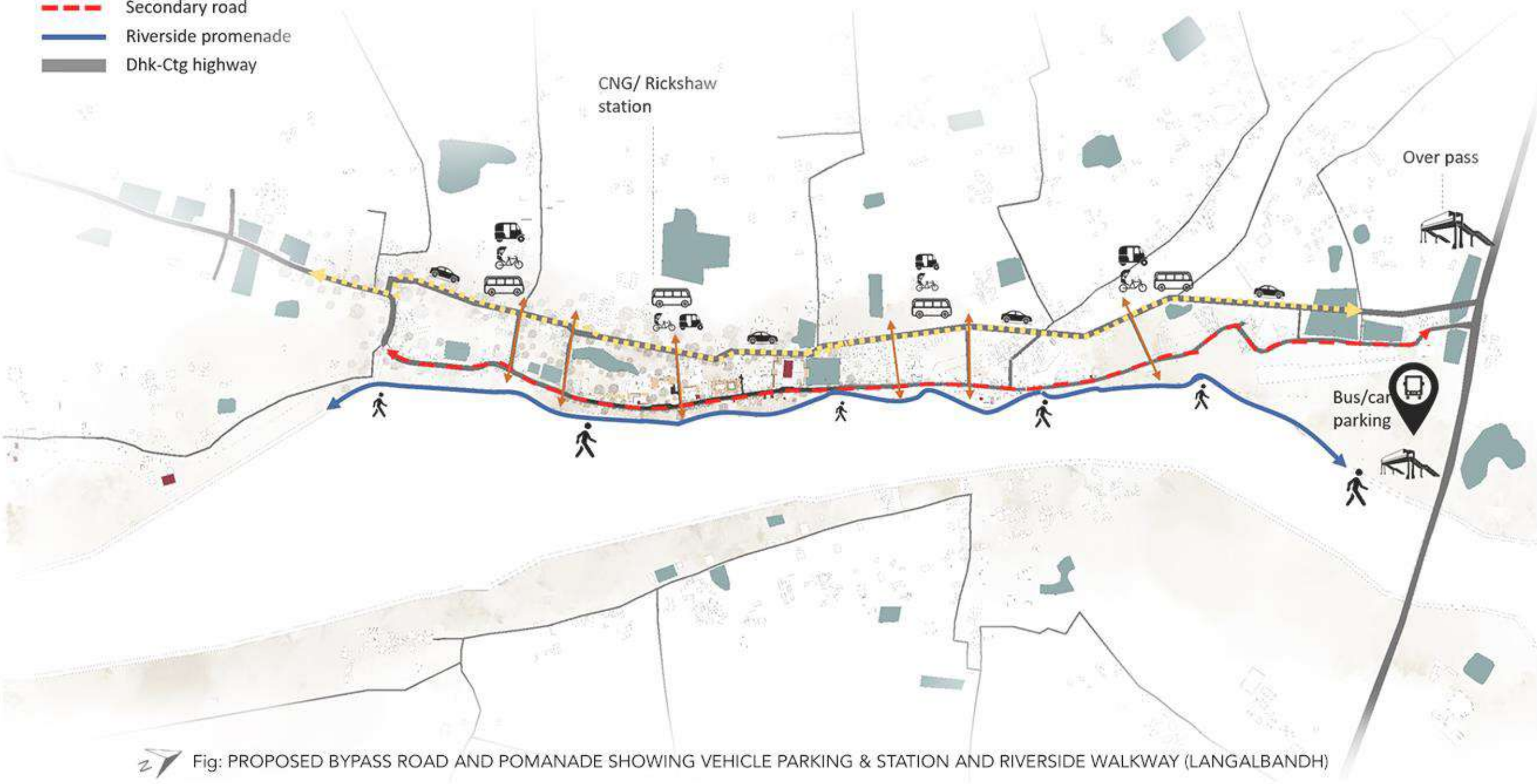



Heathcare

Accomodation

Over bridge

Administration

Parking

Religious training school

Craft market

Plaza area

Crematorium

Nursery

Multiusable pavilion

Ghat stair

Proposals

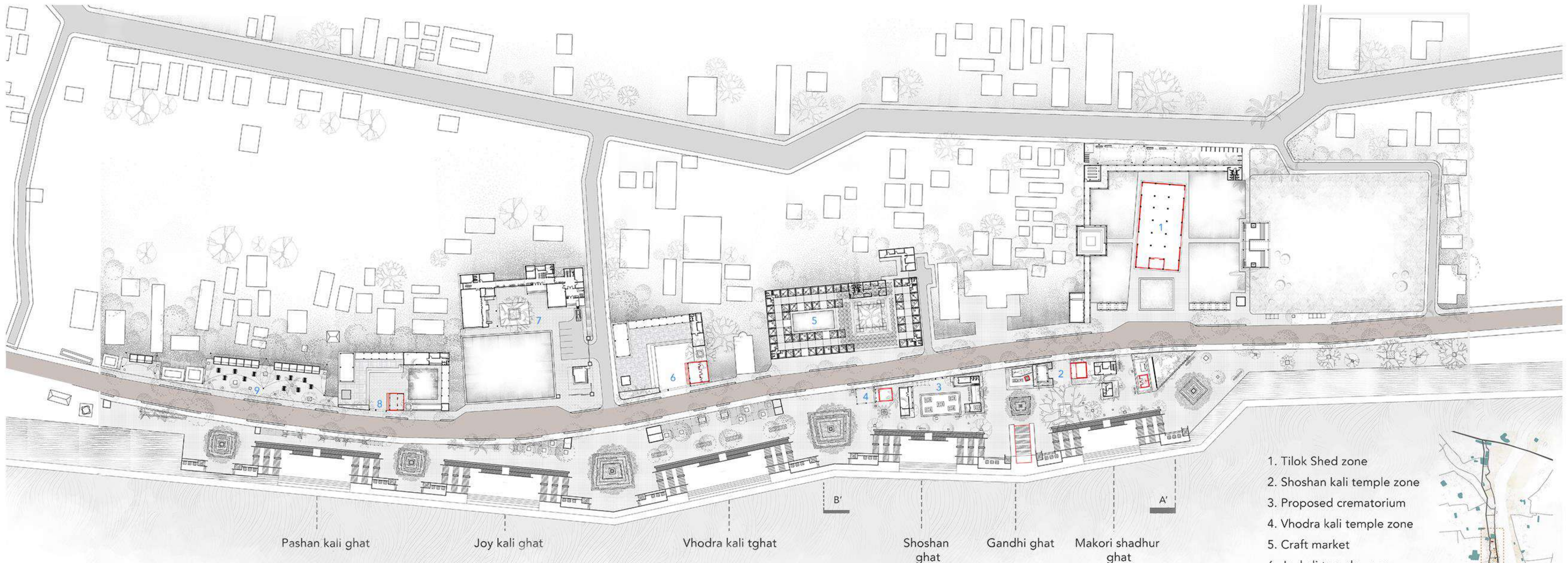

- 1. Tilok Shed zone
- 2. Shoshan kali temple zone
- 3. Proposed crematorium
- 4. Vhodra kali temple zone
- 5. Craft market
- 6. Joykali temple zone
- 7. Health care center
- 8. Pashan kali temple zone
- 9. Food stalls

DETAIL AREA PLAN (500M APPROX)



Riverside section



Riverside elevation

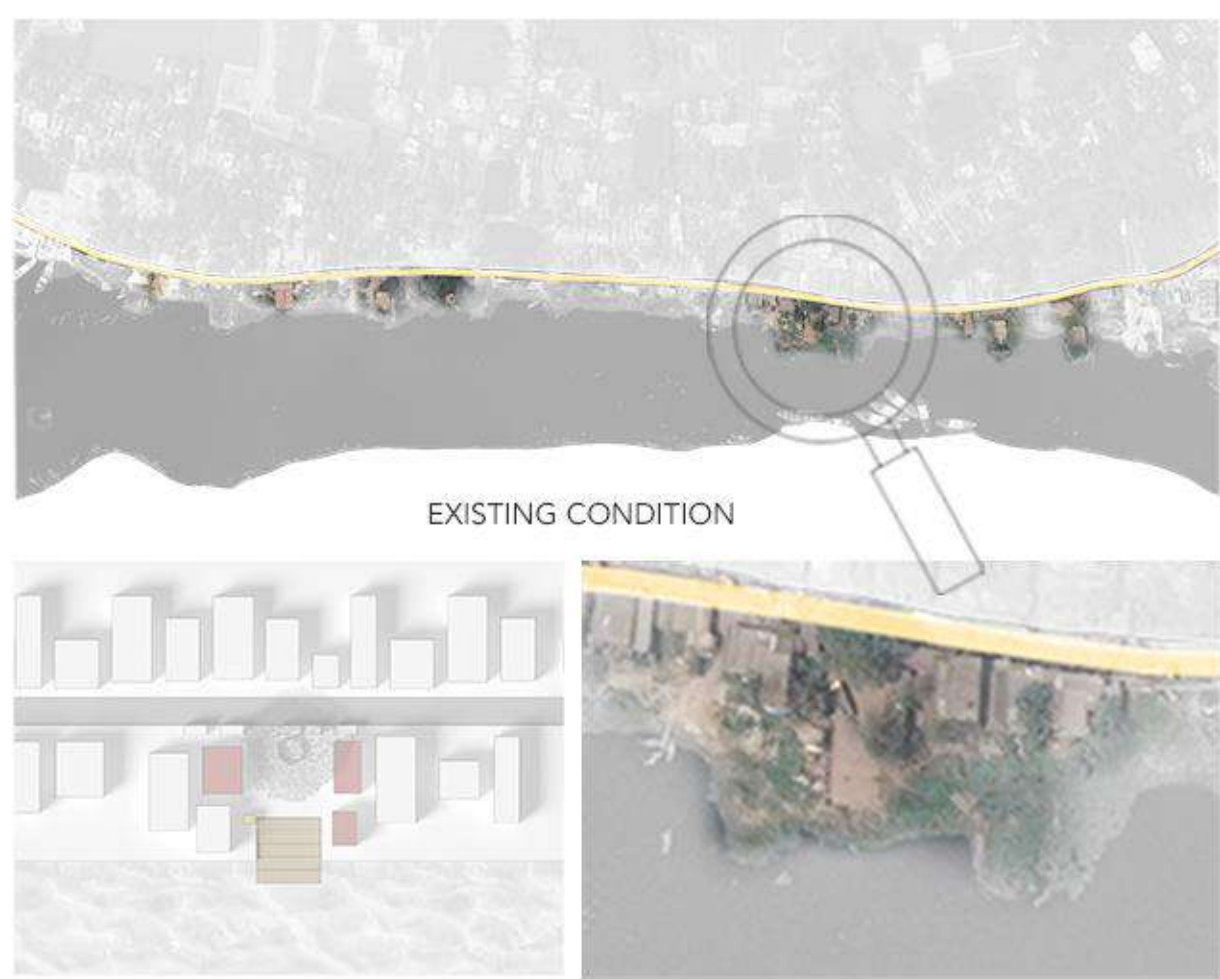

TEMPLE ROAD GHAT CROWD

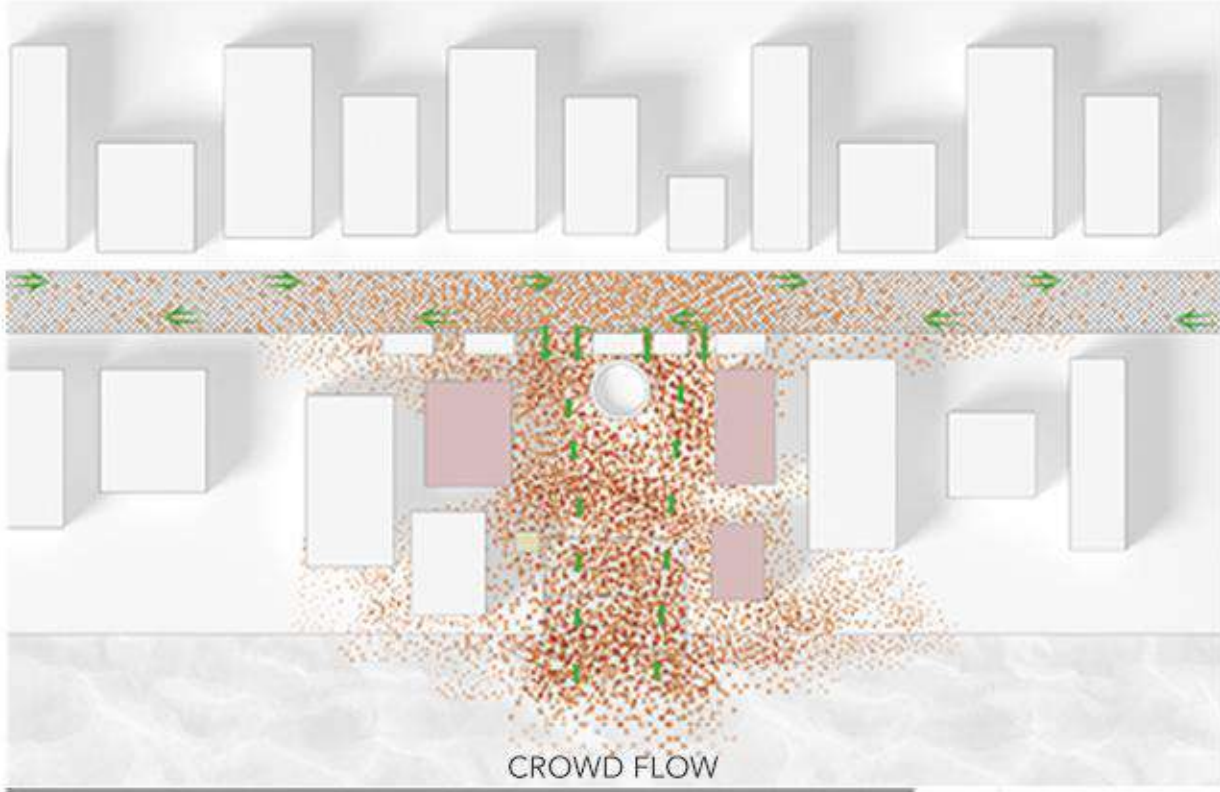

## RETHINKING GHAT

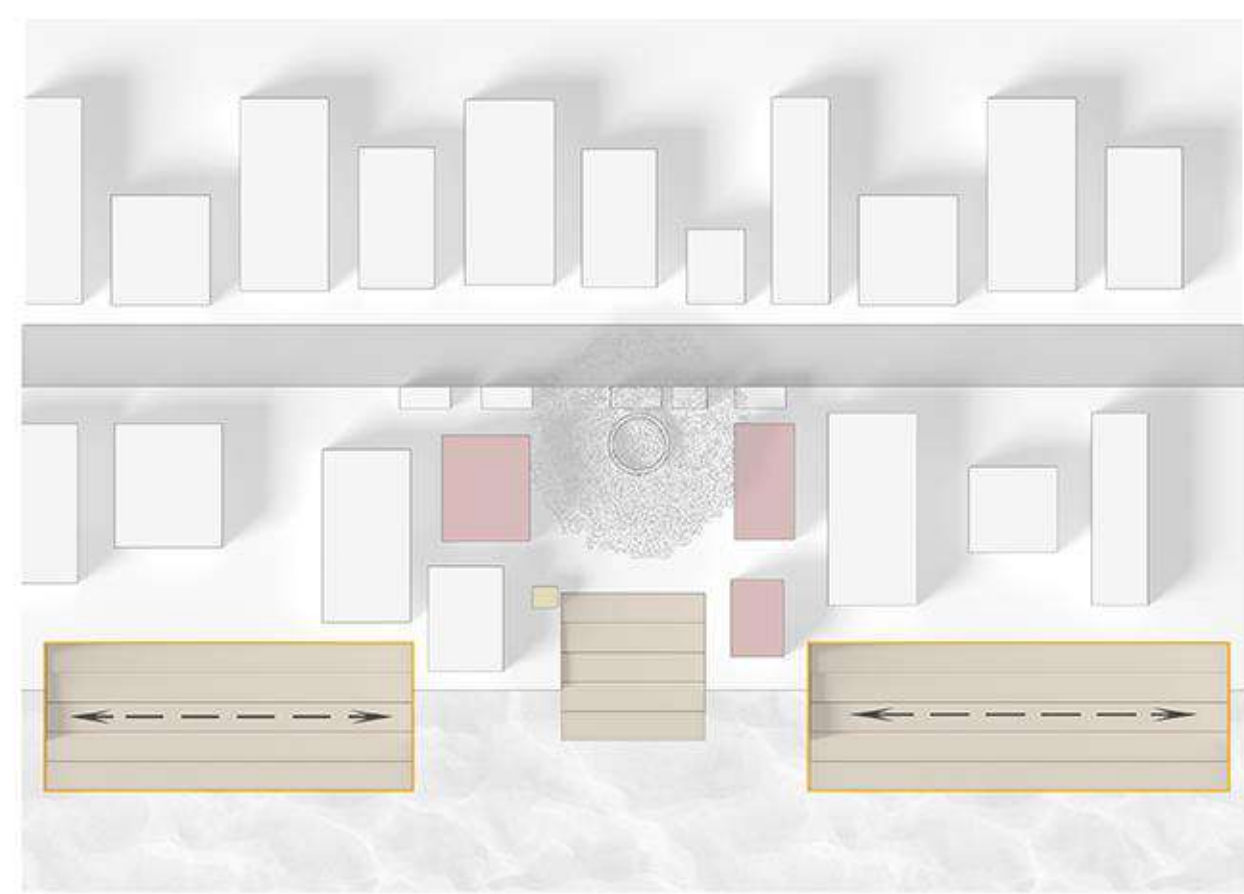
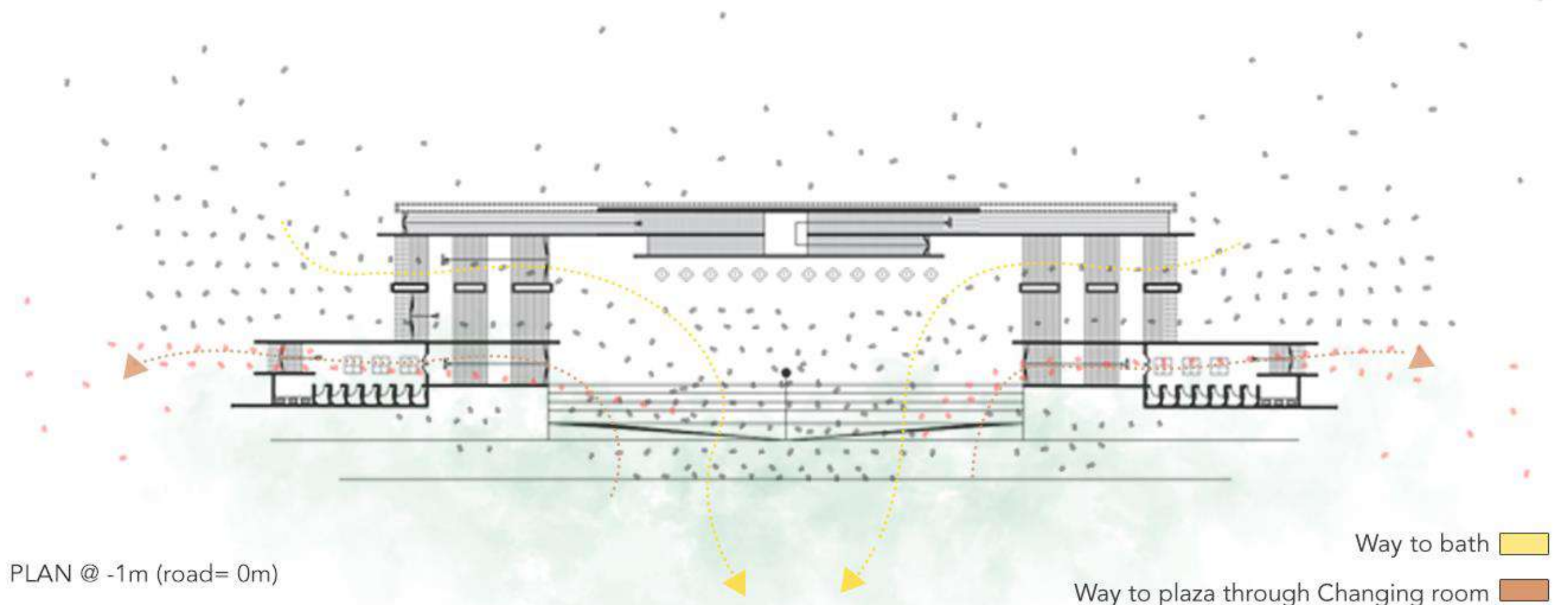
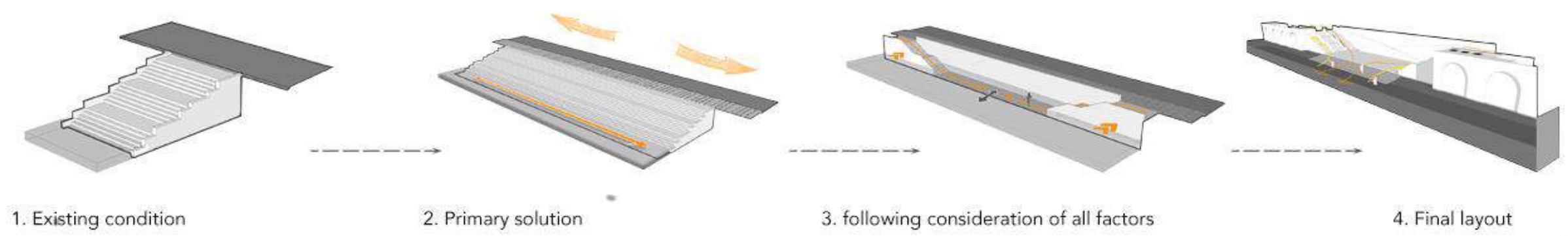

There is some cons in this simple solution.

- There is no defined gathering space during event.
- No smart solution of temporary structure.
- Circulation problem.
- The issue of the river's future width still exists in the context of such a solution.

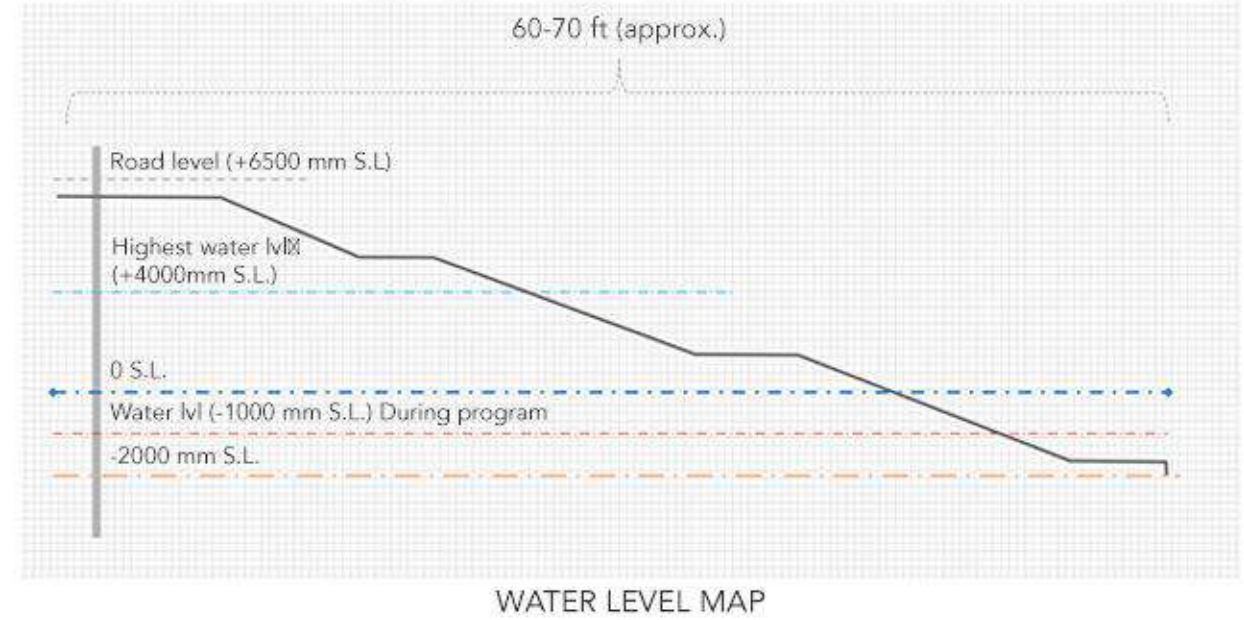

During the holy bath, the water level of the brahmaputra river goes down approx (-1 meter) sea level (S.L.). In order to meet the water at that moment, the ghat must be made 60–70 feet long, significantly reducing the river's width. In addition, cargo and passenger ships navigate the waterway. Therefore, in light of the present and the future, I believe the length of the Ghat steps should be reduced.

BASIC NEED TO RETHINK GHAT

- proper chaning room solution
- Modular approach
- proper circulation during event
- proper gathering space

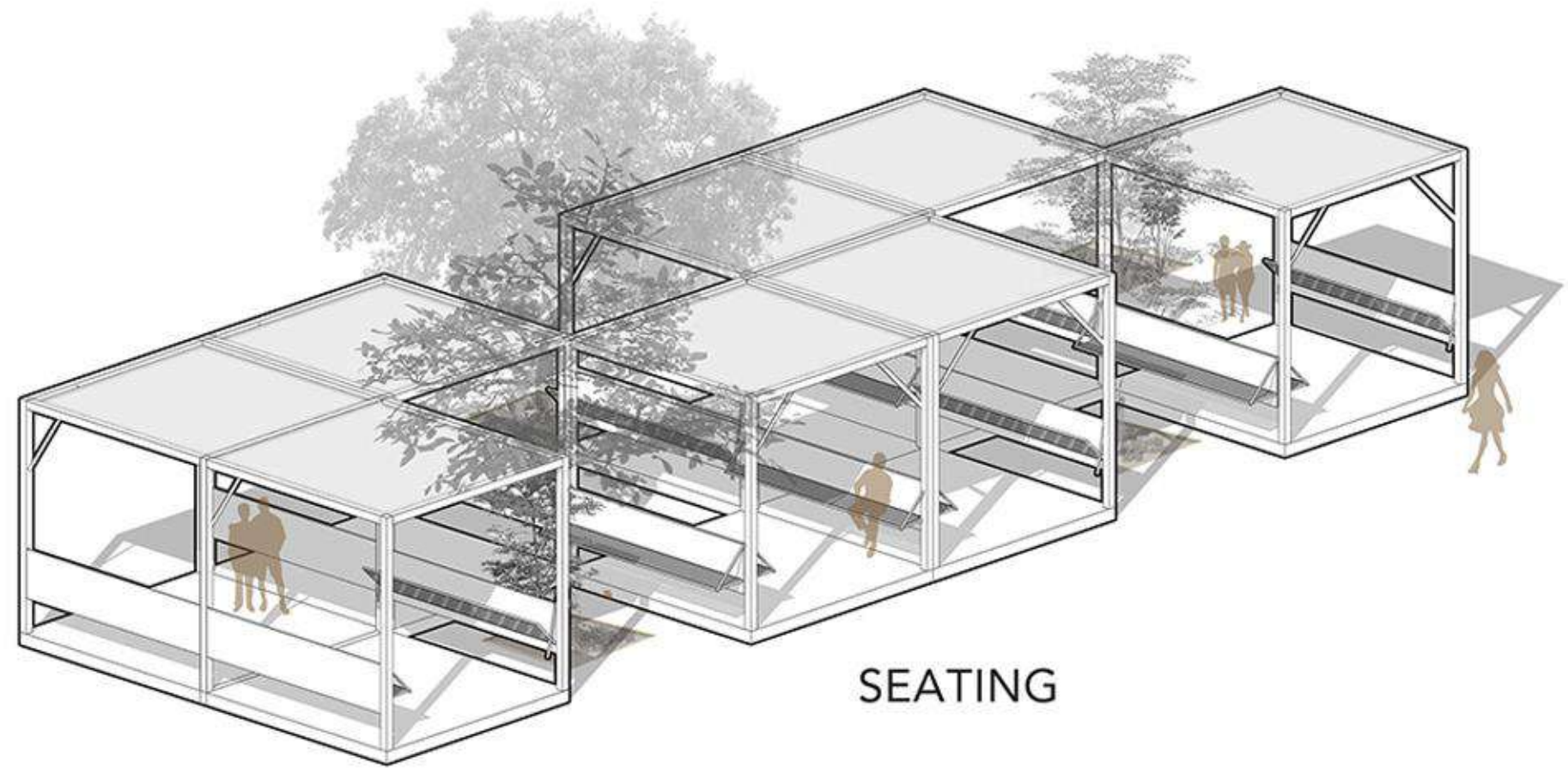

SEATING



HAAT-BAZAR



FOOD COURT & OTHERS

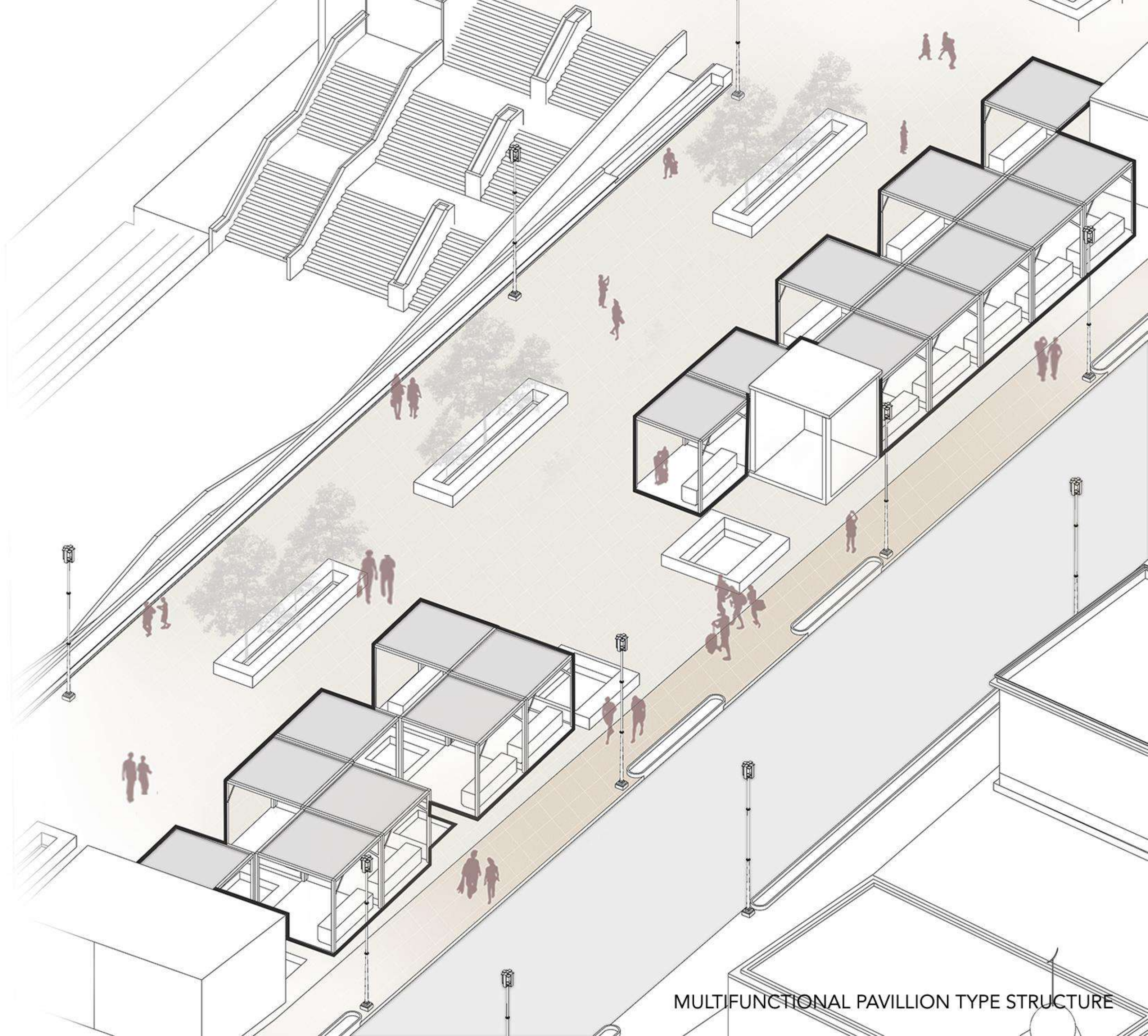

MULTIFUNCTIONAL PAVILLION TYPE STRUCTURE



# SMART POLL

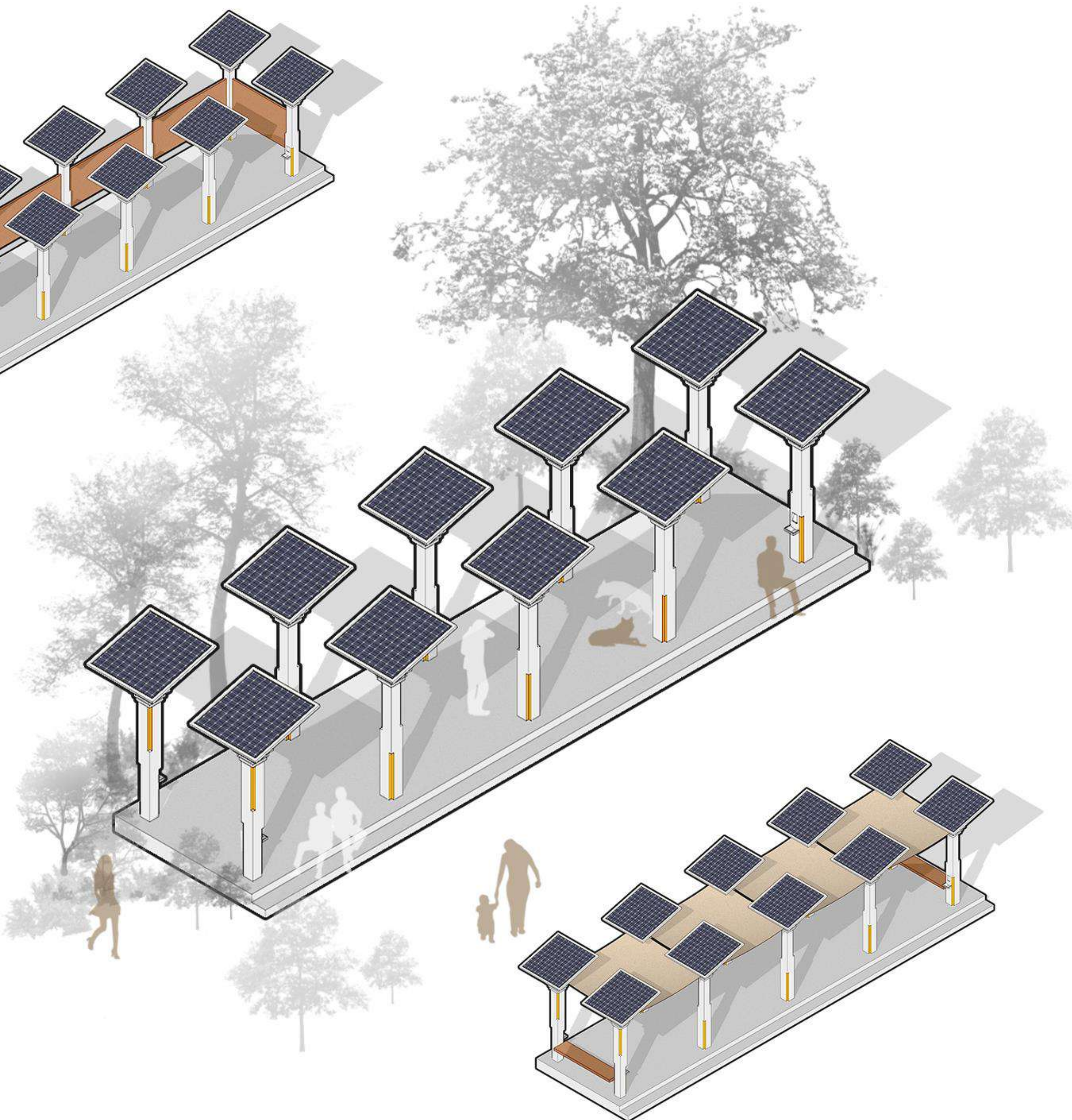
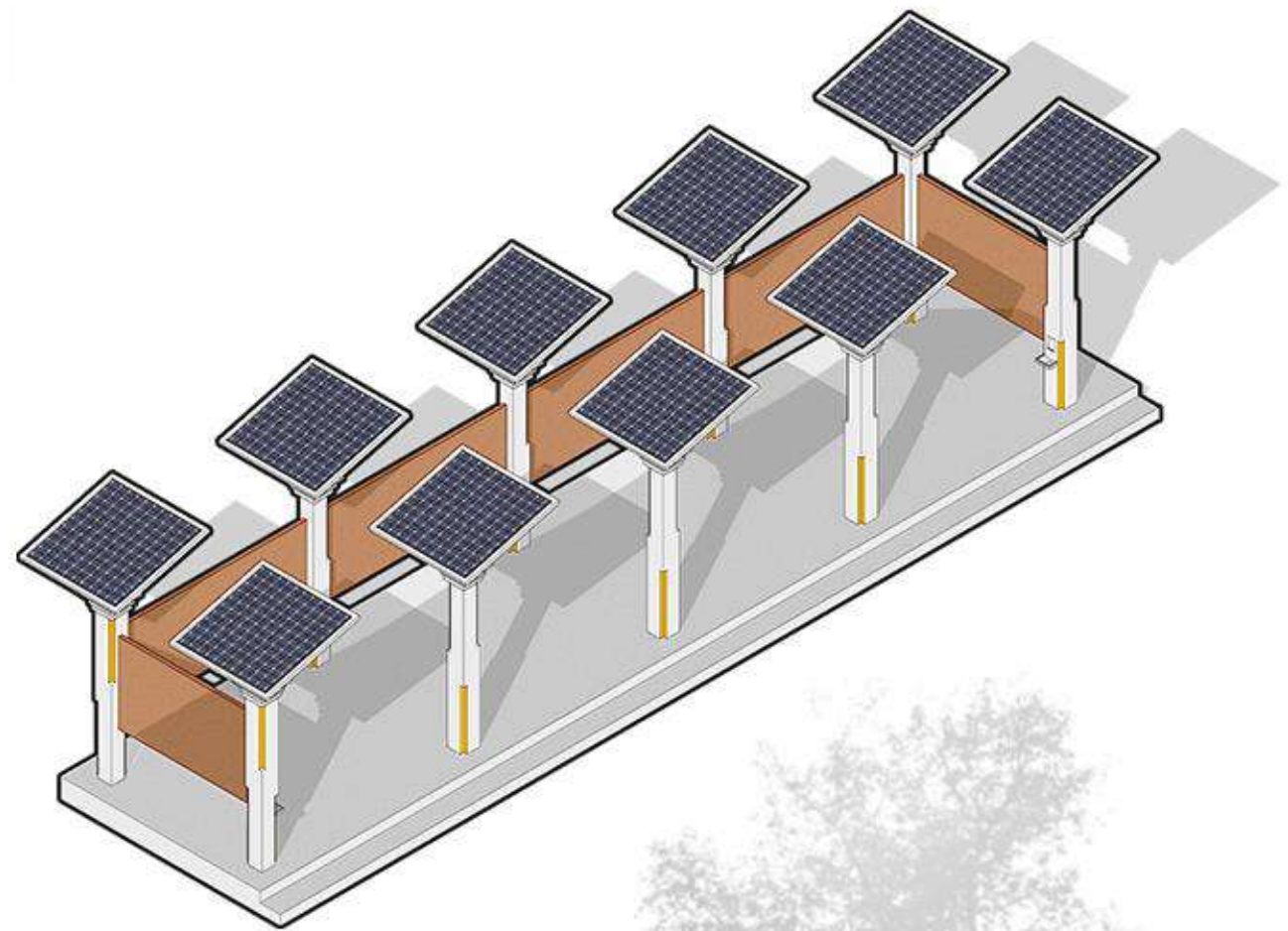
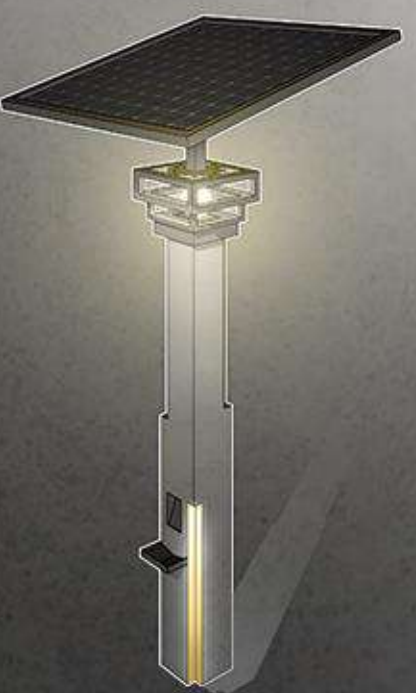
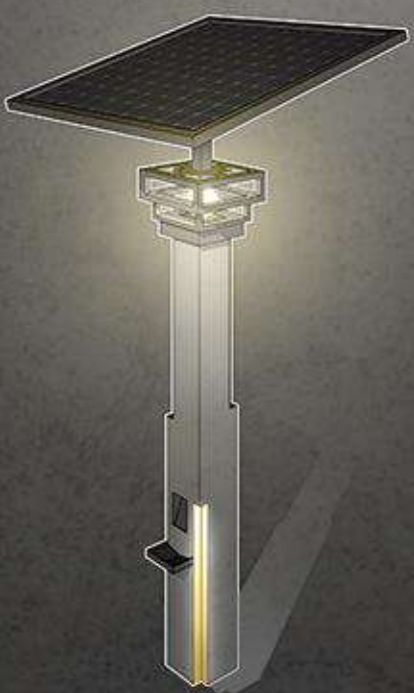
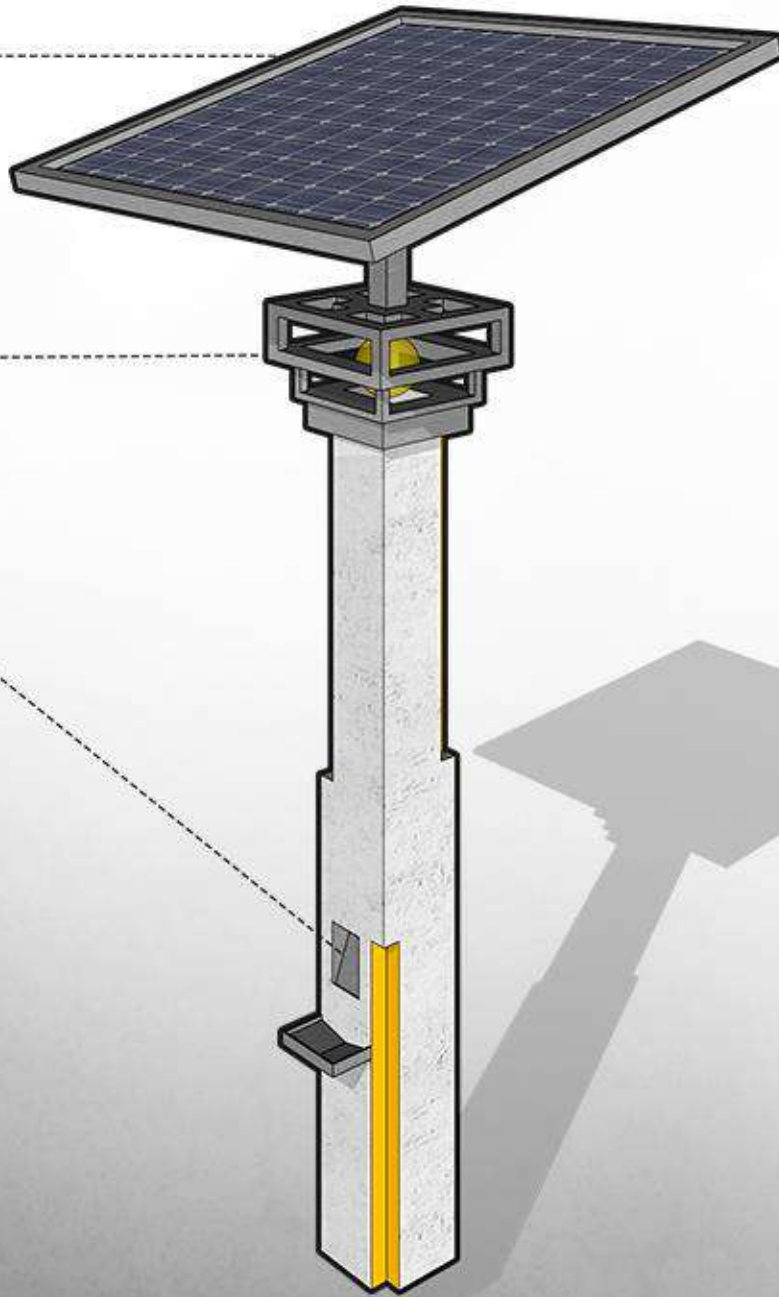

DURING PROGRAM



DURING PROGRAM

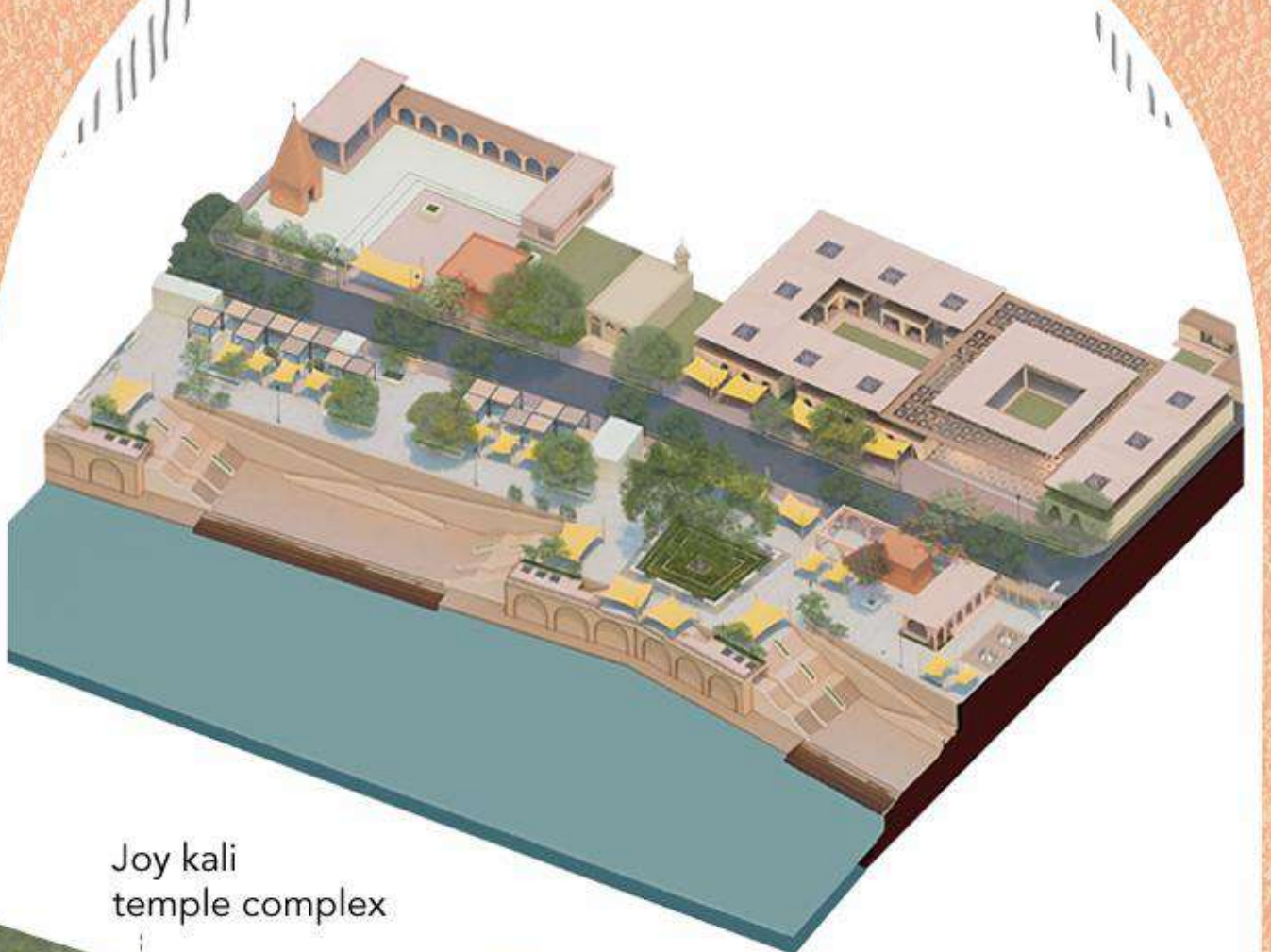

DURING PROGRAM

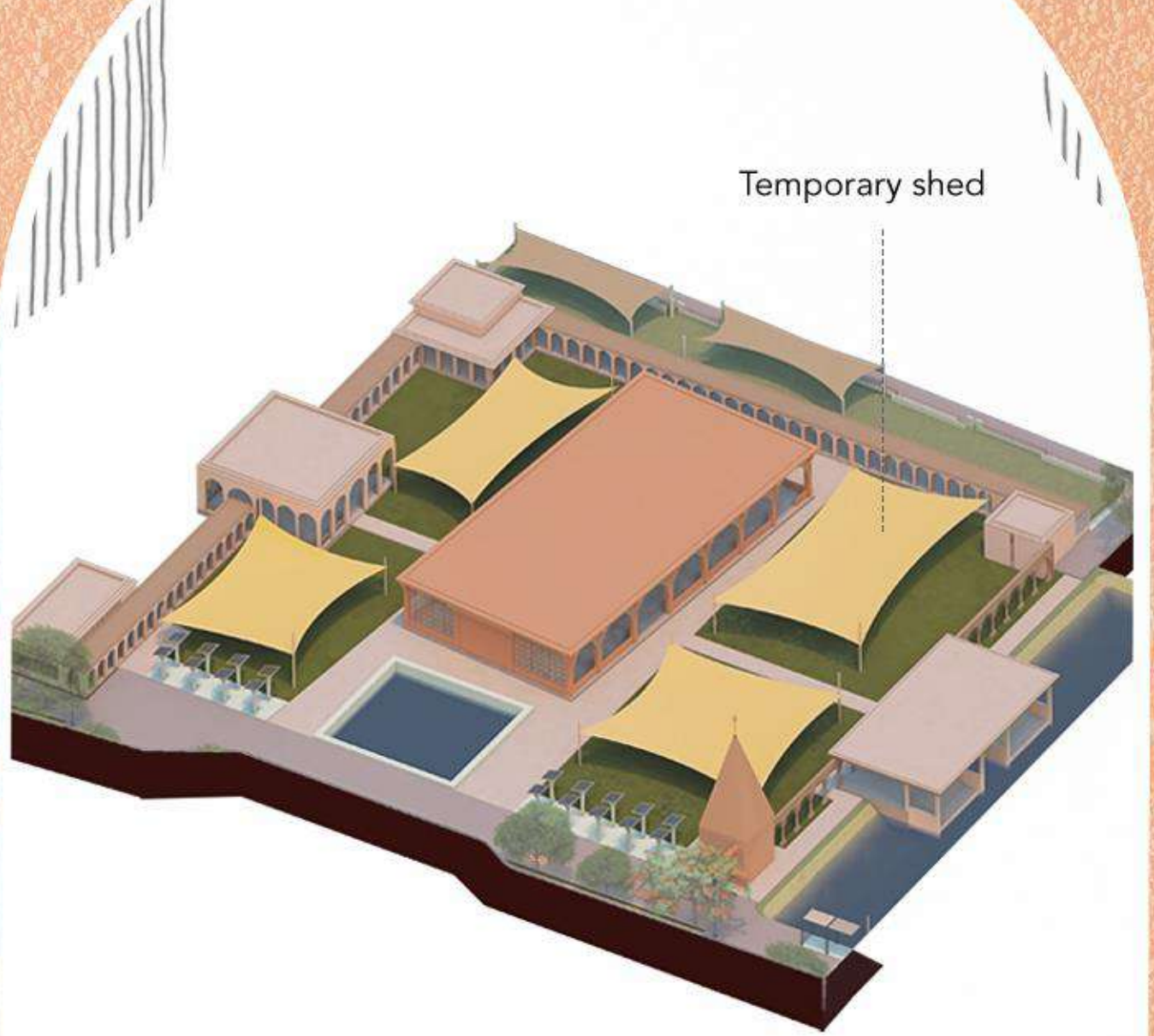

Shops & court

Health care center

Raksha kali temple complex

Joy kali temple complex

Craft market

Gandhi ghat

Tilok shed

Temporary shed

DIFFERENCE BETWEEN OFF TIME & PEAK TIME

